

Caston III

Crane Scale

- Available in 10000 lb × 5, 20000 lb × 10, 30000 lb × 20, 40000 lb × 20, 60000 lb × 20 Capacities
- Easy to Read 1.5" LED Display
- Wireless Remote Control Standard
- Environmentally Sealed to IP 67 Standards.
- Battery Operated



ISO 9001 certified

CAS
S · C · A · L · E

CASTON III Crane Scale

FEATURES

- Battery Operated w/ Low Battery Indication
- Rechargeable Battery Pack
- Spare Battery Pack and Charger Included as Standard
- Easy to Read 1.5" LED Display
- Remote Control Included as Standard
- On, Off, Zero, Tare and Hold (Manual or Automatic) Functions
- Auto Span Adjustment
- Auto Zero Tracking

SPECIFICATIONS

Model	5THD	10THD	15THD	20THD	30THD
Weighing Capacity	10000 x5lbs 5000 x2kg	20000 x10lbs 10000 x5kg	30000 x20lbs 15000 x10kg	40000 x20lbs 20000 x10kg	50000 x20lbs 30000 x10kg
Maximum Tare	Full Tare				
Display Type	LED (1.5 inch)				
Operating Power	DC 6V				
Power Source	AC 120V, 50/60Hz				
Display Designators	Zero, Tare, Hold, Batt.				
Power Consumption	1.2W				
Operating Temperature	-10 °C ~ +40 °C (14 °F ~ 104 °F)				

※ Over 60,000 lbs : Special Order



▲ Display & Keyboard

◀ Battery pack Installation

DIMENSIONS

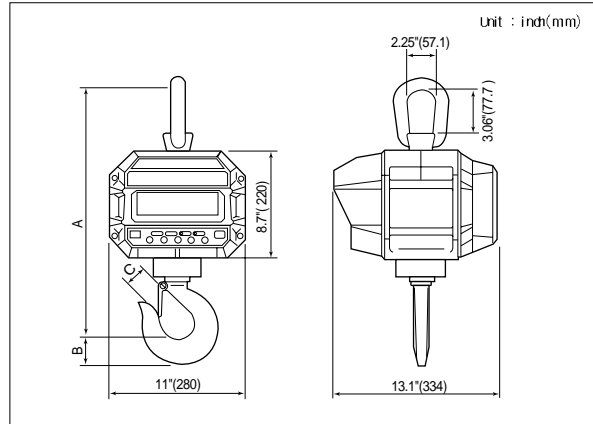

Model	A	B	C	Product Weight
5THD	20.1" (512)	1.75" (44.5)	1.69" (42.9)	68.3 lb / 31 kg

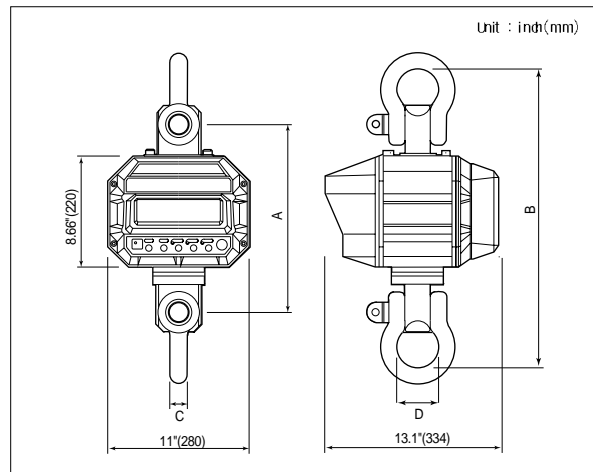

Model	A	B	C	D	Product Weight
10 THD	14.8" (377)	25.3" (642)	1.26" (32)	3.27" (83)	75 lb / 34 kg
15 THD	15" (382)	28.2" (716)	1.5" (38)	3.89" (99)	76.3 lb / 34.6 kg
20 THD	15.2" (387)	31.1" (793)	1.77" (45)	4.96" (126)	77.4 lb / 35.1 kg



CAS USA Corporation

NJ OFFICE
99 Murray Hill Parkway
East Rutherford, NJ 07073
Tel: (201) 933-9002
Fax: (201) 933-9025

<http://www.cas-usa.com>

CA OFFICE
733 S. State College Blvd #98
Fullerton, CA 92831
Tel: (714) 870-1286
Fax: (714) 870-1167

Specifications are subject to change for improvement without prior notice.

2001. 7